

ADL 89501a  
Kg\m 1,137  
AA: 359 mm<sup>2</sup>\m

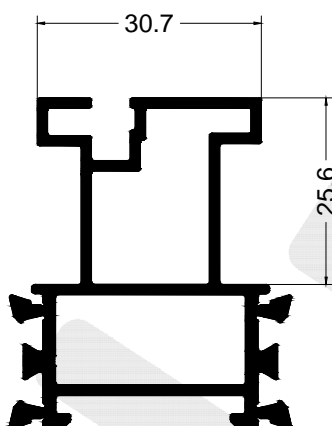

ADL 89507  
Kg\m 0,969  
AA: 284 mm<sup>2</sup>\m

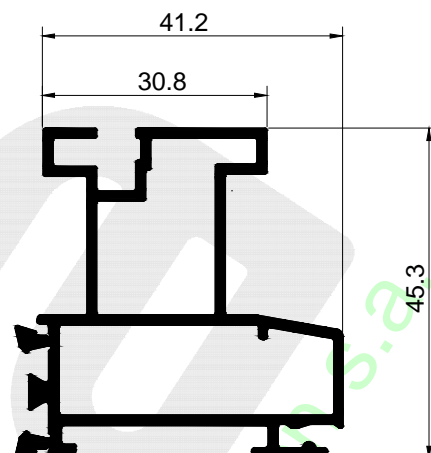

ADL 89502  
Kg\m 0,967  
AA: 285 mm<sup>2</sup>\m

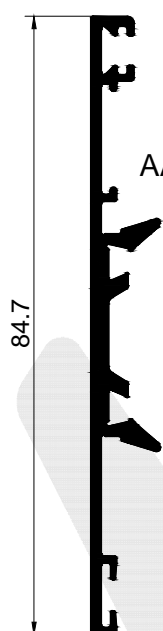

ADL 89504c  
Kg\m 0,615  
AA: 264 mm<sup>2</sup>\m

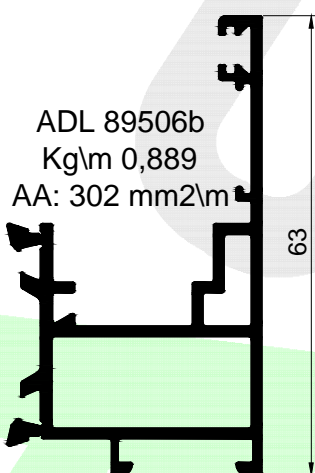

ADL 89506b  
Kg\m 0,889  
AA: 302 mm<sup>2</sup>\m

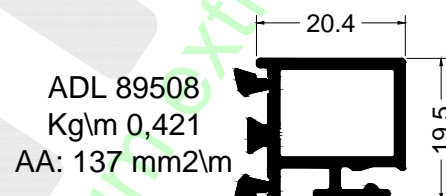

ADL 89508  
Kg\m 0,421  
AA: 137 mm<sup>2</sup>\m

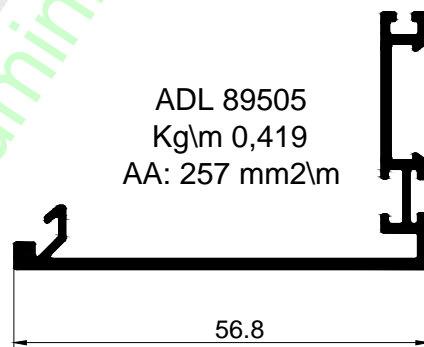

ADL 89505  
Kg\m 0,419  
AA: 257 mm<sup>2</sup>\m

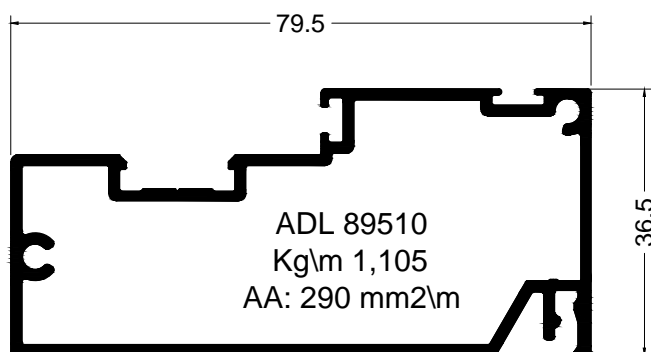

ADL 89510  
Kg\m 1,105  
AA: 290 mm<sup>2</sup>\m



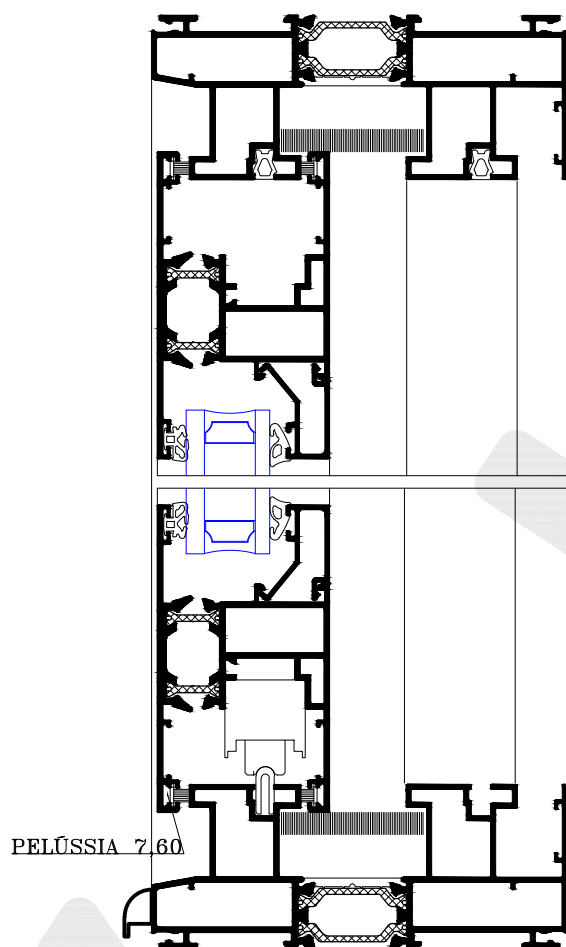

**CORTE A-A**

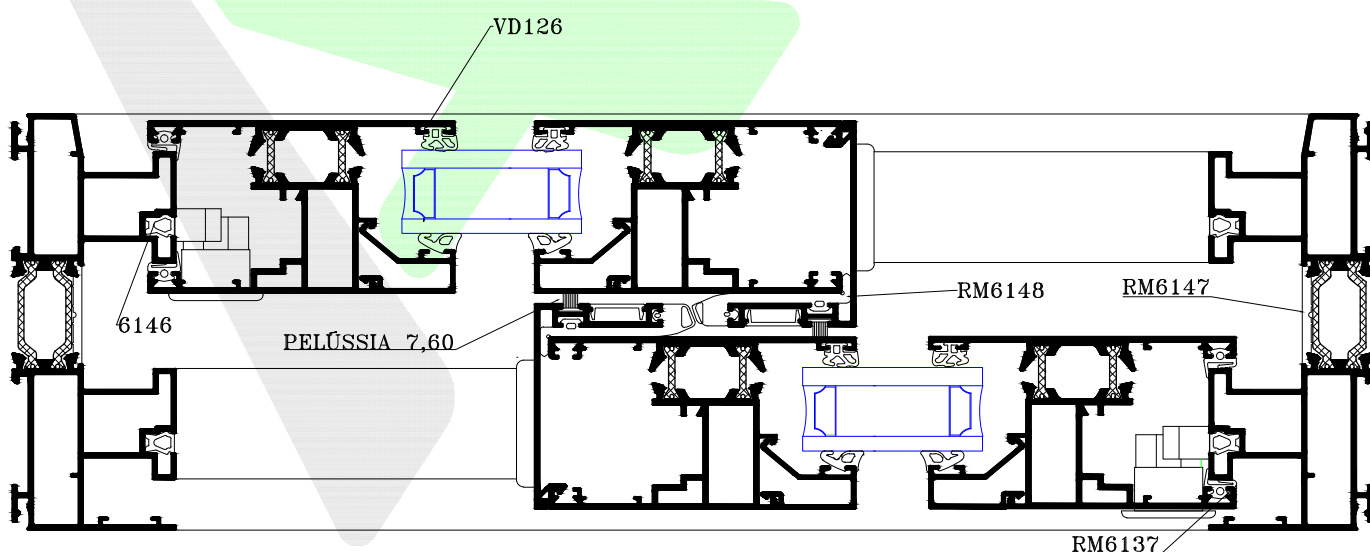
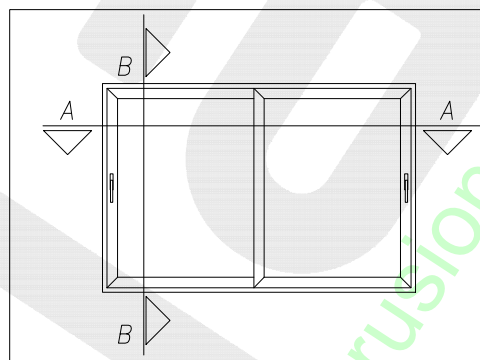

**CORTE B-B**

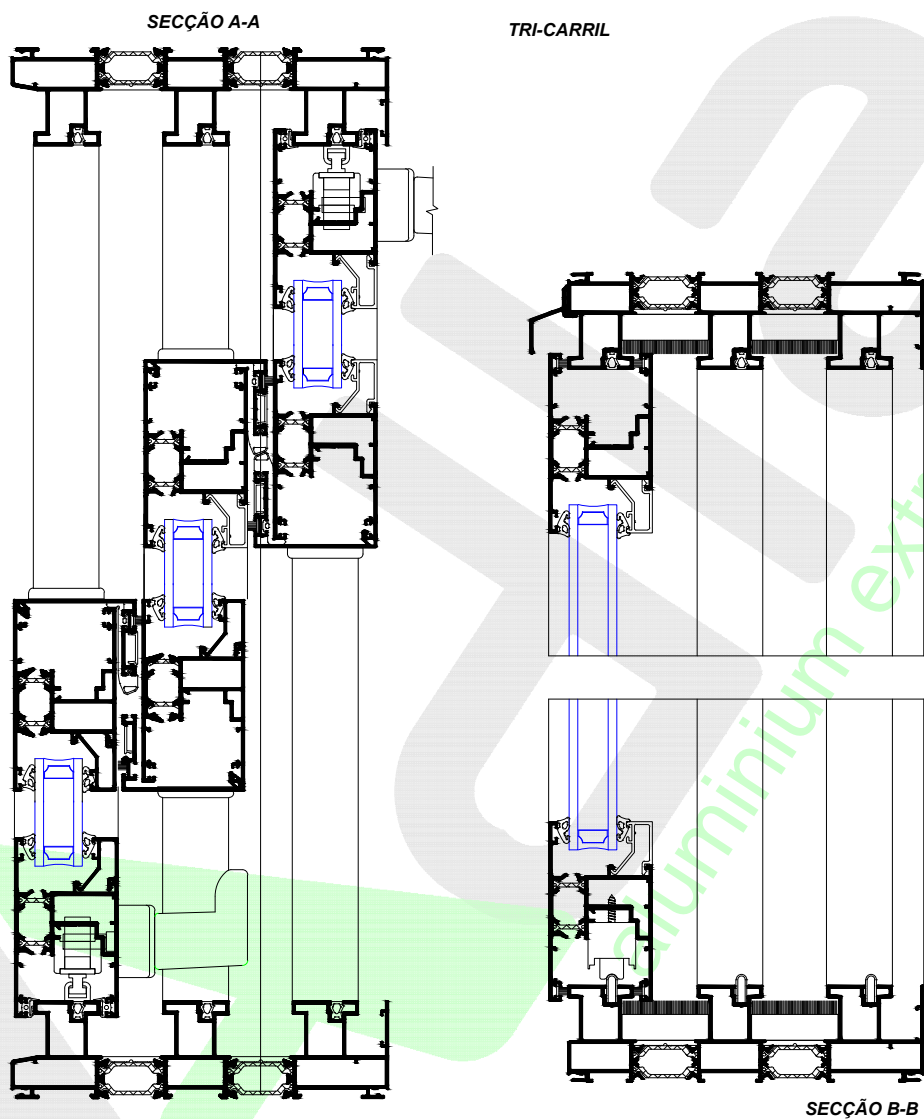



**SECÇÃO B-B**

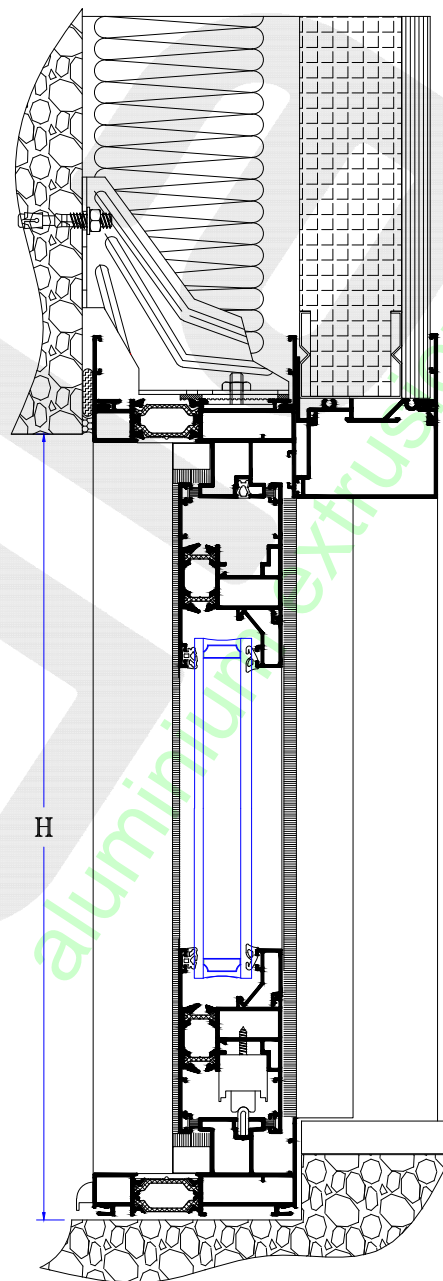
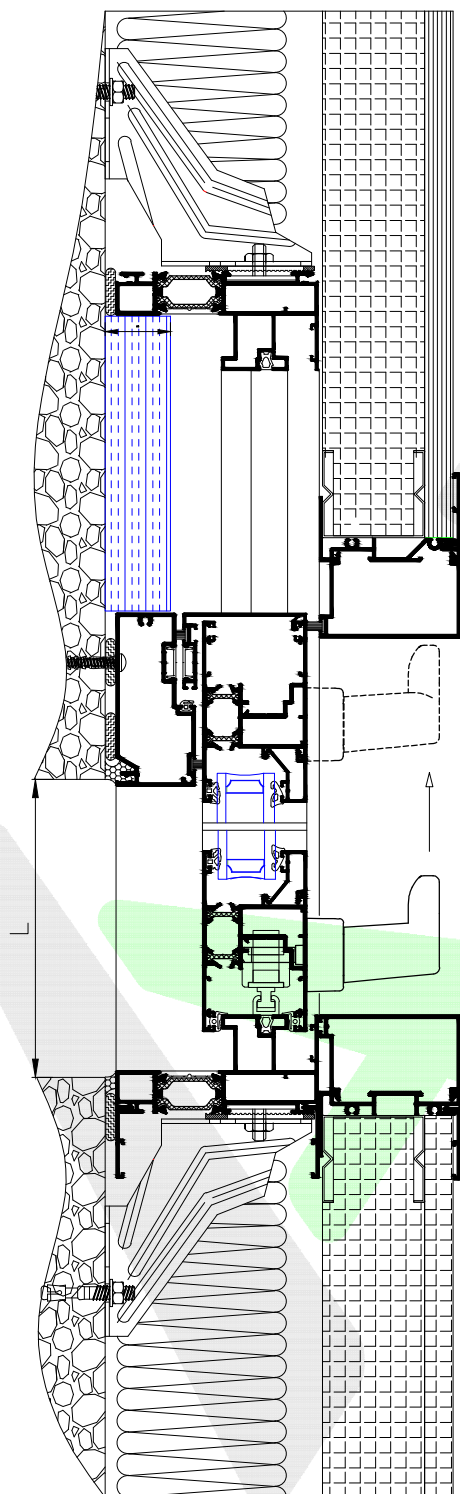

**SECÇÃO A-A**

## ENSAIO DO TIPO INICIAL

Boletim de ensaio nº CXL042/16

UC/ITECONS Organismo notificado nº 2211



Janela com perfis de alumínio com corte térmico do sistema ADL 89500 RT com duas folhas de correr.

Dimensão da janela:  
2642 mm x 2242 mm

## COEFICIENTE DE TRANSMISSÃO TÉRMICA

Relatório nº CXL041/16 Organismo

notificado nº 2211

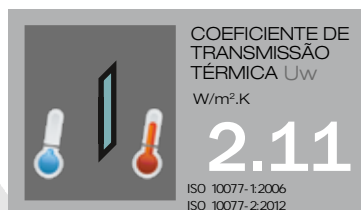

Dimensão da janela:  
2642 mm x 2242 mm  
 $U_g = 1.0 W/m^2.K$

## DESEMPENHO ACÚSTICO

Informação de cálculo nº ACL 153/16

Organismo notificado nº 2211

